



Laakfeld

SHOWER CURTAIN ROD

»LINDA«

INSTRUCTIONS &
SAFETY NOTICES

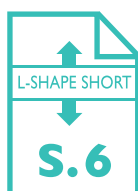
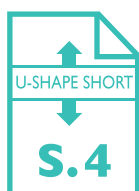

Preface

Thank you for choosing a Laakfeld product. We will be happy to guide you through the installation of the shower curtain rod. In the following instructions, all the necessary steps are described carefully and in detail.

At **www.laakfeld.de** you will find more information, answers to the most frequently asked questions, as well as this manual for download.

Do you have further questions?

No problem!

Contact us anytime:

kontakt@laakfeld.de

We recommend that you set up horizontally on the floor. To avoid scratching the floor, please use a carpet pad, e.g. a blanket.

CAUTION! Make sure that you do not pinch your skin or other body parts when setting up. Also make sure that the individual parts that are to be connected according to these instructions are securely connected. Also make sure that you do not injure yourself on the edges. We recommend that two people carry out the assembly.

Intended use

The shower curtain rod is designed for domestic use in the bathroom and is not suitable for professional, commercial or industrial use. The shower curtain rod is designed to hold shower curtains commonly used in the bathroom. Neither excessively heavy nor potentially dangerous items may be hung there. The shower curtain rod must not be used as a pull-up bar or for any other purpose other than its intended use.

Safety instructions

Please read the instructions carefully before assembly and keep them in a safe place. Assembly should only be carried out by adults, children should not be in the vicinity during assembly. Packaging materials and small parts must not get into the hands of children. After assembly, the stability must be tested and checked at regular intervals.

Contents

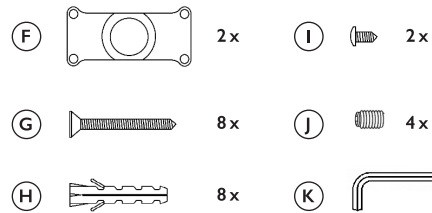
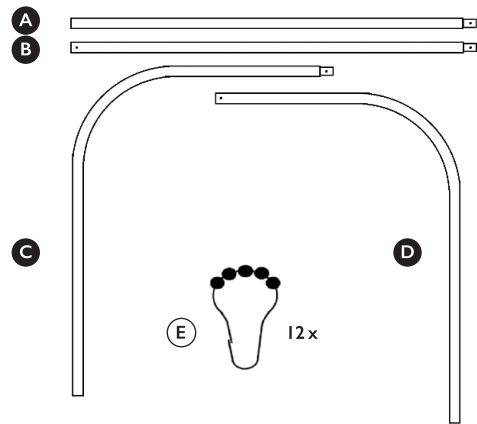

- A** 1x straight bar with **one** drill hole
- B** 1x straight bar with **two** drill holes
- C** 1x curved rod with a taper
- D** 1x curved rod without taper
- E** 12x shower curtain rings with sliding system
- F** 2x wall brackets
- G** 8x screws for fixing the wall bracket to the wall
- H** 8x dowels
- I** 2x small screws to connect the individual bars
- J** 4x small set screws for fastening the rods to the wall bracket
- K** 1x Allen wrench to install the four small set screws

Also needed

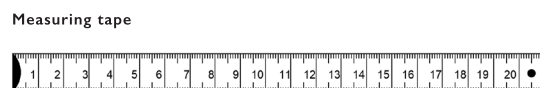
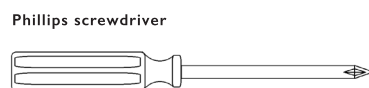

Drill with 6 mm drill attachment – depending on the surface different drill bits are suitable. More information on drilling in tiles can be found on page 6.

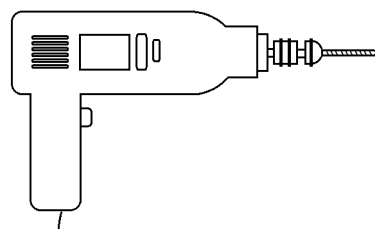

Variants



VARIANT I

U-SHAPE SHORT



VARIANT 2
U-SHAPE LONG



VARIANT 3 A/B
L-SHAPE SHORT



VARIANT 4 A/B
L-SHAPE LONG

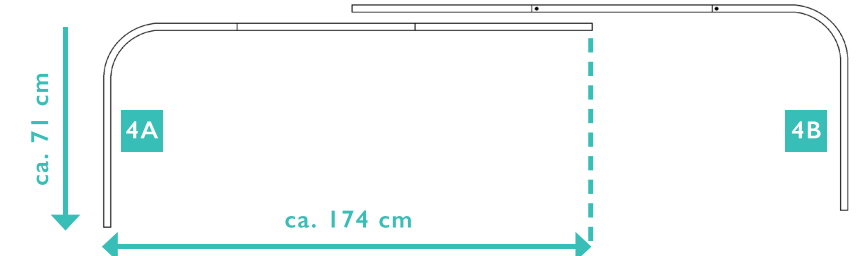
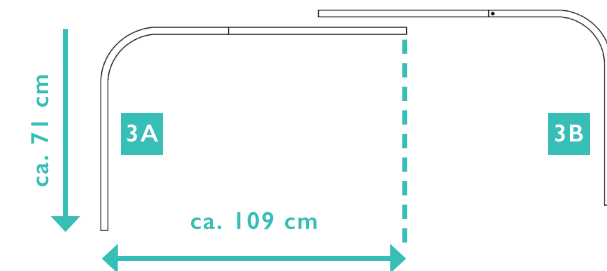
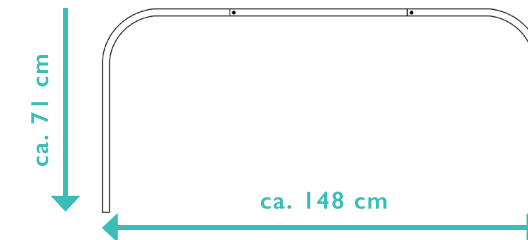
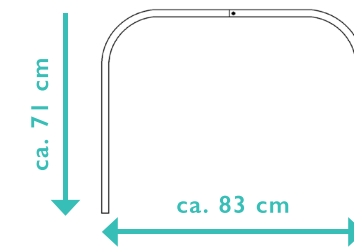

Instructions for drilling into tiles

- Mark the places where you want to drill according to the assembly instructions.
- Use a scribing needle or a nail to lightly punch the glaze of the tile at the previously marked point to prevent the drill from slipping off.
- Stick two strips of transparent adhesive tape over the grained areas to prevent the drill from slipping and splintering off the edge of the drill hole.
- Depending on the scratch hardness of the tiles, we recommend using a glass or tile drill for soft materials (scratch hardness up to 3), a masonry drill bit for medium-hard materials (scratch hardness 4 to 7) and a stone drill bit for hard porcelain stoneware or modern natural stone tiles (from scratch hardness 8) a diamond drill bit. Info: The scratch hardness (also Mohs hardness) is a method of measuring hardness and indicates the resistance a material offers against a sharp-edged object. The scale ranges from 1 (very soft) to 9 (very hard). In the bathroom, tiles with a scratch hardness of 3–5 are usually used.
- Make sure that the hammer function of the drill is switched off.
- Carefully drill through the tile, with low pressure and low speed.
- As soon as you have drilled through the tile, you should change to a normal masonry drill bit, otherwise the special drill will wear out very quickly.

NOTES ON INDIVIDUAL SHORTENING

- For variants 3 and 4, you have the option of shortening the length individually with a hacksaw.
- Important: Shortening can only be done on the rod (A) and only on the side where is no hole.

Assembly instructions

FOR VARIANT 1 (U-SHAPE SHORT)

STEP 1: For the first step you need the two curved rods (C) and (D) and the shower curtain rings (E). The rods (A) and (B) are not needed for this variant. Connect the two curved rods (C) and (D) by joining the two rods at the ends of the shorter side (the sides where the holes are located). Please make sure that the holes of the rods (C) and (D) are directly on top of each other. Then put the required number of shower curtain rings (E) over the rod. We recommend inserting the opening of the shower curtain rings (E) uniformly in the direction of the shower.

STEP 2: Now you need the two wall brackets (F), a small screw (I), four small set screws (J) as well as the Allen key (K) and a Phillips screwdriver. Attach rods (C) and (D) together by turning the small screw (I) through the holes in rods (C) and (D) with the screwdriver and tightening. Make sure that the head of the small screw (I), which fixes the two rods, points upwards. Now put the wall brackets (F) onto the two rods (C and D). There are two holes on the wall brackets through which the set screws are guided. Position the wall brackets so that the long sides of the wall brackets (F) are perpendicular to the wall and the holes of the brackets are therefore on the top and bottom of the rods (C and D). The hole that is closer to the end of the shower curtain rod (i.e. closer to the wall) points upwards. Make sure the rods (C and D) are all the way into the wall brackets (F) and now secure the wall brackets (F) to the round rods (C and D) with the four small set screws (J) and the Allen wrench (K).

STEP 3: You should perform the following steps with another person – you will now need a sharp pencil or similar and a tape measure. Hold the shower curtain rod in its final position. To make sure that the rod hangs straight, we recommend measuring the height of the wall brackets (F). Make sure that the wall brackets (F) are straight and now use the pencil to mark the positions where the screw holes of the wall brackets are present. Now you can put down the shower curtain rod for the time being.

STEP 4: For the last step you need a drill with a 6 mm diameter drill bit, eight dowels (H) and the eight screws (G). First, use a meter to check if there are any power or water lines behind the planned drilling location. If you plan to drill through tiles, please be sure to follow the separate instructions on page 5. First drill holes at the previously marked locations and insert the dowels (H) into the eight holes created. Now place the shower curtain rod at its destination again and fasten it with four screws (G) per wall bracket in the dowels. First check the stability and hang your shower curtain (not included) on the shower curtain rings.

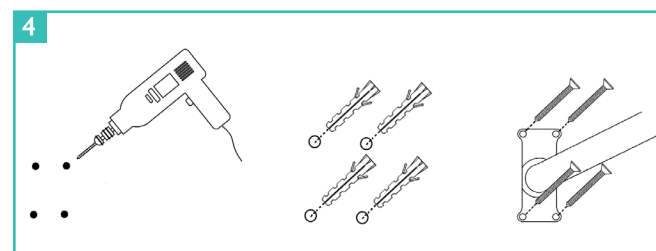
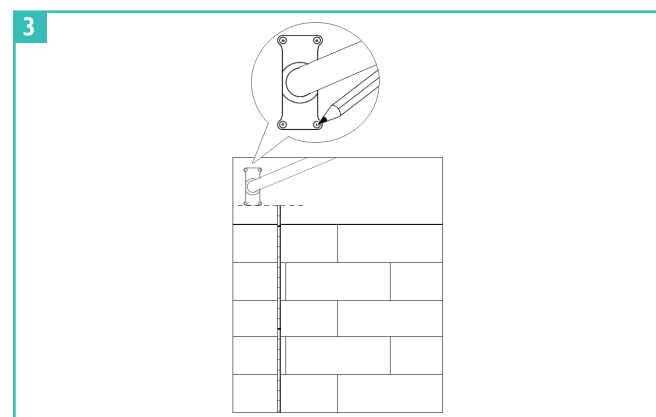
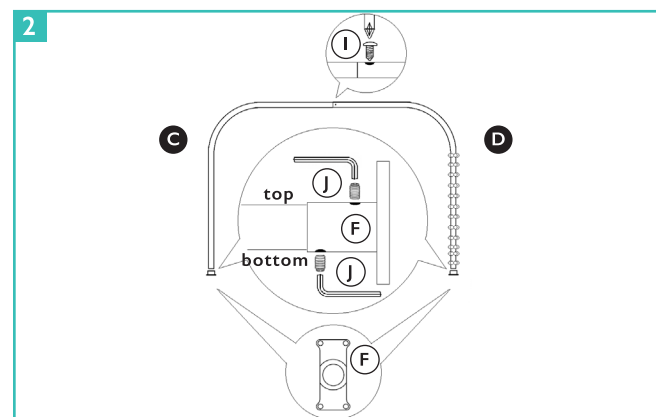
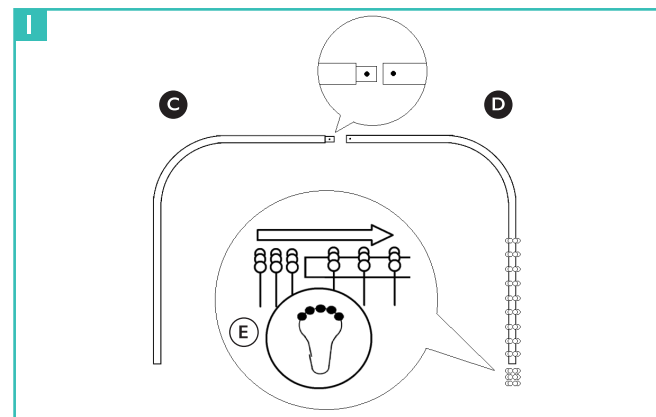

Problem solutions and
FAQs on Page 8
contact: kontakt@laakfeld.de

Assembly instructions

FOR VARIANT 2 (U-SHAPE LONG)

STEP 1: For the first step, you will need the straight rod (B), the two curved rods (C) and (D) and the shower curtain rings (E). The rod (A) is not needed for this variant. Connect rods (B) and (C) and rods (B) and (D) by joining the tapered end of rod (C) to the end without taper of rod (B) and the tapered end of rod (D) to the end without taper of rod (B) at the end of the shorter side (the side where the hole is). Please make sure that the holes of the rods (B) and (C) and the rods (B) and (D) are directly above each other. Then slip the required number of shower curtain rings (E) over the rod. We recommend inserting the opening of the shower curtain rings (E) uniformly in the direction of the shower.

STEP 2: Now you need the two wall brackets (F), two small screws (I), four small set screws (J) as well as the Allen key (K) and a Phillips screwdriver. Attach rods (B) and (C) and (B) and (D) together by using the screwdriver to thread the small screws (I) through the holes in rods (B) and (C) and (B) and (D) and tighten. Make sure that the head of the small screws (I), which fix the rods, point upwards. Now put the wall brackets (F) onto the two curved rods (C and D). There are two holes on the wall brackets through which the set screws are guided. Position the wall brackets so that the long sides of the wall brackets (F) are perpendicular to the wall and the holes of the brackets are therefore on the top and bottom of the rods (C and D). The hole that is closer to the end of the shower curtain rod (i.e. closer to the wall) points upwards. Make sure the rods (C and D) are all the way into the wall brackets (F) and now secure the wall brackets (F) to the round rods (C and D) with the four small set screws (J) and the Allen wrench (K).

STEP 3: You should perform the following steps with another person – you will now need a sharp pencil or similar and a tape measure. Hold the shower curtain rod in its final position. To make sure that the rod hangs straight, we recommend measuring the height of the wall brackets (F). Make sure that the wall brackets (F) are straight and now use the pencil to mark the positions where the screw holes of the wall brackets are present. Now you can put down the shower curtain rod for the time being.

STEP 4: For the last step, you will need a drill with a 6 mm diameter drill, eight dowels (H) and eight screws (G). First check with a measuring device whether there are any power or water lines behind the planned drilling point. If you plan to drill through tiles, please be sure to follow the separate instructions on page 5. First drill holes at the previously marked locations and insert the dowels (H) into the eight holes created. Now place the shower curtain rod at its destination again and fasten it with four screws (G) per wall bracket in the dowels. First check the stability and hang your shower curtain (not included) on the shower curtain rings.

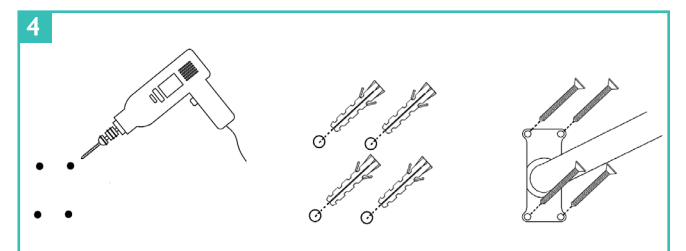
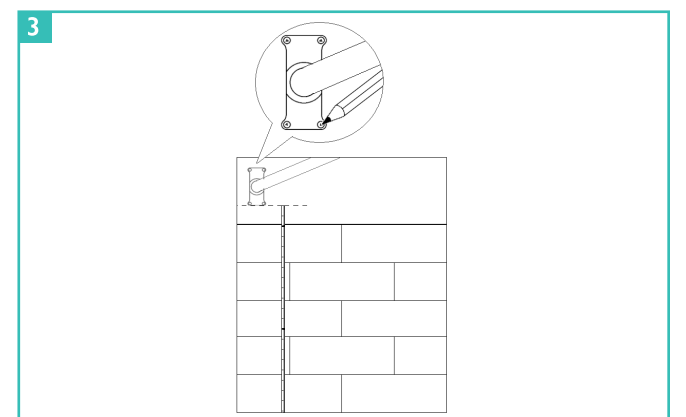
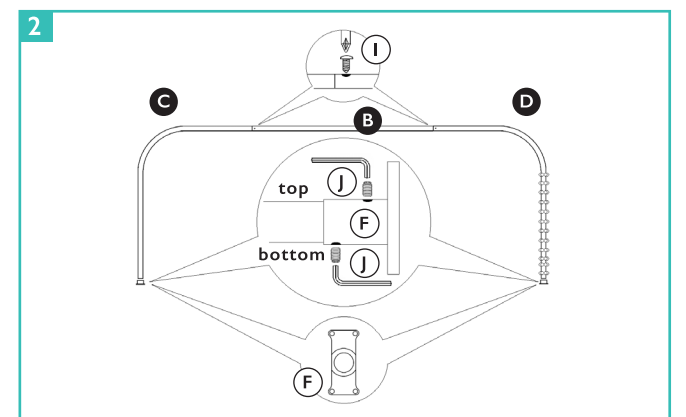
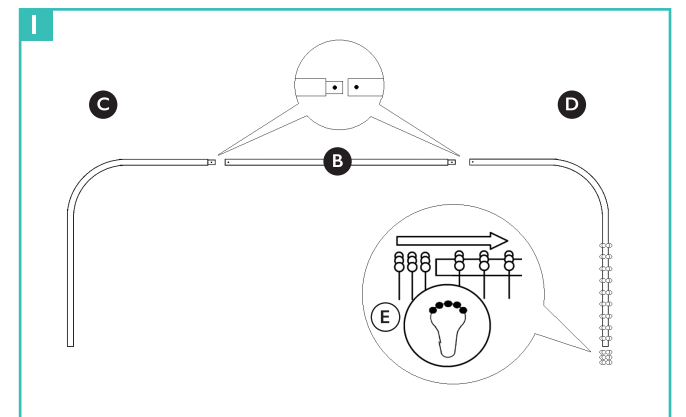

Problem solutions and
FAQs on Page 8
contact: kontakt@laakfeld.de

Assembly instructions

FOR VARIANT 3A AND 3B (L-SHAPE SHORT)

STEP 1: For the first step you need the straight rod (A), the curved rod (D) and the shower curtain rings (E). The rods (B) and (C) are not needed for this variant. Connect the rods (A) and (D) by joining the rod (D) at the end of the shorter side (the sides where the hole is located) with the tapered end of the rod (A). Please make sure that the holes of the rods (A) and (D) are directly on top of each other. Then put the required number of shower curtain rings (E) over the rod. We recommend inserting the opening of the shower curtain rings (E) uniformly in the direction of the shower.

STEP 2: Now you need the two wall brackets (F), a small screw (I), four small set screws (J) as well as the Allen key (K) and a Phillips screwdriver. Attach rods (A) and (D) together by turning the small screw (I) through the holes in rods (A) and (D) with the screwdriver and tightening. Make sure that the head of the small screw (I), which fixes the rods, points upwards in variant 3B (see page 3). In variant 3A, the head of the screw points downwards. Now push the wall holders (F) onto the rods (A and D). There are two holes on the wall brackets through which the set screws are guided. Position the wall brackets so that the long sides of the wall brackets (F) are perpendicular to the wall and the holes in the brackets are therefore at the top and bottom of the rods (A and D). The hole that is closer to the end of the shower curtain rod (i.e. closer to the wall) points upwards. Make sure the rods (A and D) are all the way into the wall brackets (F) and now secure the wall brackets (F) to the rods (A and D) with the four small set screws (J) and the Allen wrench (K).

STEP 3: The following steps should be done with another person - you will need a sharp pencil or similar and a tape measure. Hold the shower curtain rod in its final position. To make sure that the rod is hanging straight, we recommend measuring the height of the wall brackets (F). Make sure that the wall brackets (F) are straight and now use the pencil to mark the positions where the screw holes of the wall brackets are present. Now you can put down the shower curtain rod for the time being.

STEP 4: For the last step, you will need a drill with a 6 mm diameter bit, eight dowels (H) and the eight screws (G). First, use a meter to check if there are any power or water lines behind the planned drilling location. If you plan to drill through tiles, please be sure to follow the separate instructions on page 5. First drill holes at the previously marked locations and insert the dowels (H) into the eight holes created. Now place the shower curtain rod at its destination again and fasten it with four screws (G) per wall bracket in the dowels. First check the stability and hang your shower curtain (not included) on the shower curtain rings.

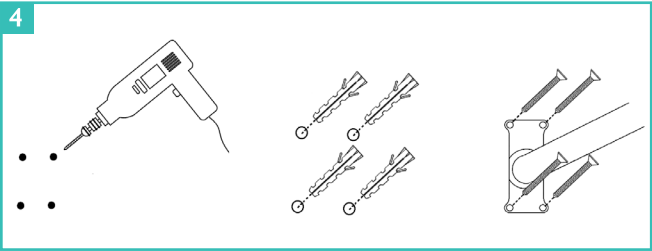
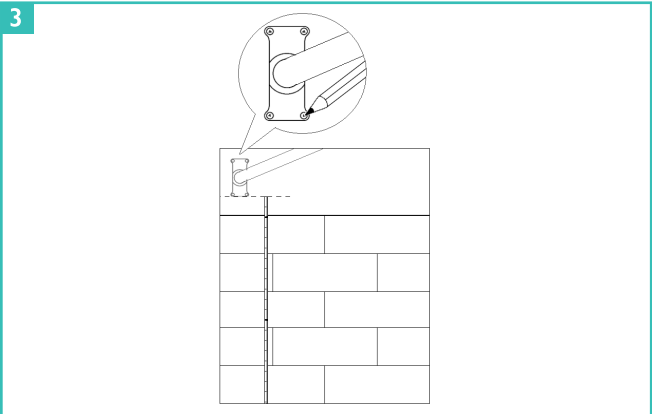
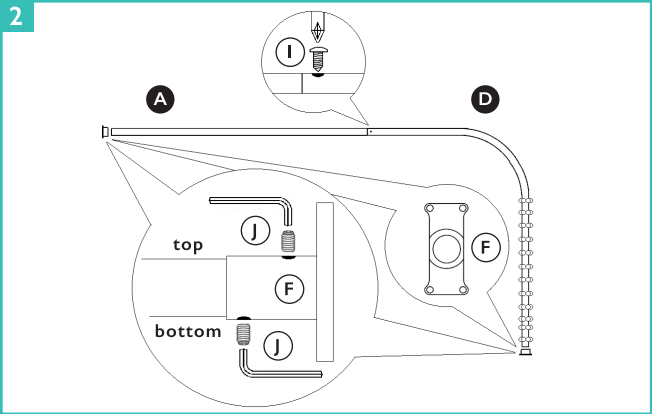
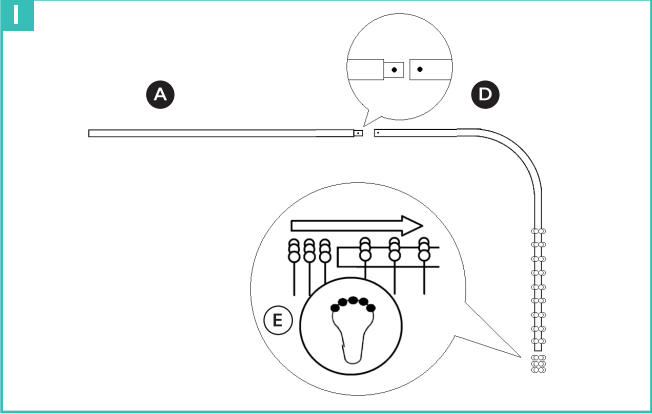

Problem solutions and
FAQs on Page 8
contact: kontakt@laakfeld.de

Assembly instructions

FOR VARIANT 4A AND 4B (L-SHAPE LONG)

STEP 1: For the first step you need the straight rods (A) and (B), the curved rod (D) and the shower curtain rings (E). The rod (C) is not needed for this variant. Connect rods (A) and (B) and rods (B) and (D) by joining the tapered end of rod (A) to the end without taper of rod (B) and the tapered end of rod (B) to rod (D) at the end of the shorter side (the side where the hole is located). Please make absolutely sure that the holes of the rods (A) and (B) as well as the rods (B) and (D) are directly above each other. Then put the required number of shower curtain rings (E) over the rod. We recommend opening the We recommend that the opening of the shower curtain rings (E) is placed uniformly in the direction of the shower.

STEP 2: Now you need the two wall brackets (F) two small screws (I), four small set screws (J) as well as the Allen key (K) and a Phillips screwdriver. Fasten rods (A) and (B) and rods (B) and (D) together by turning the small screws (I) through the holes in rods (A) and (B) and rods (B) and (D) with the screwdriver and tightening. Make sure that the heads of the small screws (I), with which the rods are fixed, point upwards in variant 4B (see page 3). In variant 4A, the screw heads point downward. Now push the wall holders (F) onto the rods (A and D). There are two holes on the wall brackets through which the set screws are guided. Position the wall brackets so that the long sides of the wall brackets (F) are perpendicular to the wall and the holes in the brackets are therefore at the top and bottom of the rods (A and D). The hole that is closer to the end of the shower curtain rod (i.e. closer to the wall) points upwards. Make sure the rods (A and D) are all the way into the wall brackets (F) and now secure the wall brackets (F) to the rods (A and D) with the four small set screws (J) and the Allen wrench (K).

STEP 3: The following steps should be done with another person - you will need a sharp pencil or similar and a tape measure. Hold the shower curtain rod in its final position. To make sure that the rod hangs straight, we recommend measuring the height of the wall brackets (F). Make sure that the wall brackets (F) are straight and now use the pencil to mark the positions where the screw holes of the wall brackets are present. Now you can put down the shower curtain rod for the time being.

STEP 4: For the last step, you will need a drill with a 6 mm diameter bit, eight dowels (H) and the eight screws (G). First, use a meter to check if there are any power or water lines behind the planned drilling location. If you plan to drill through tiles, please be sure to follow the separate instructions on page 5. First drill holes at the previously marked locations and insert the dowels (H) into the eight holes created. Now place the shower curtain rod at its destination again and fasten it with four screws (G) per wall bracket in the dowels. First check the stability and hang your shower curtain (not included) on the shower curtain rings.

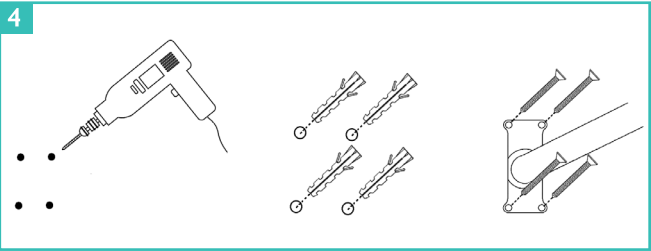
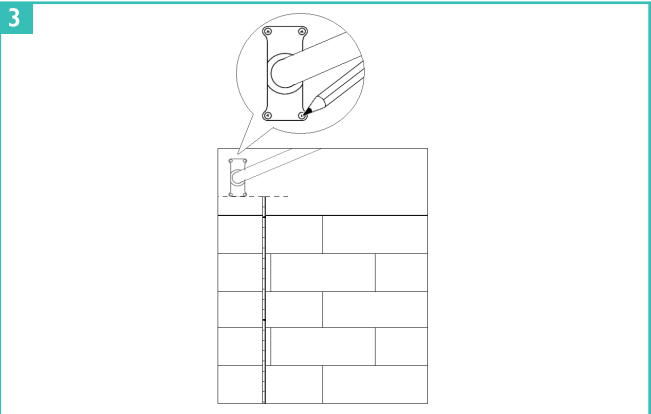
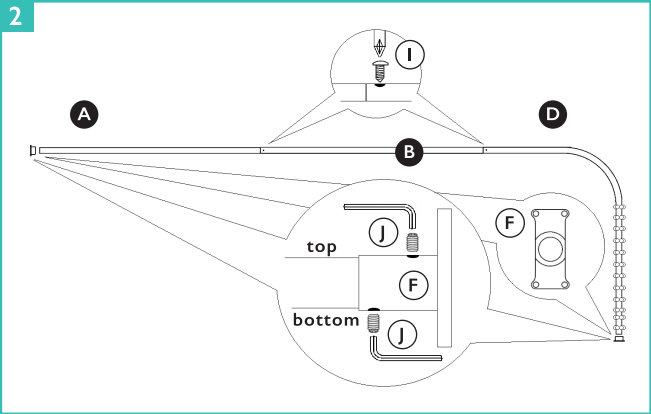
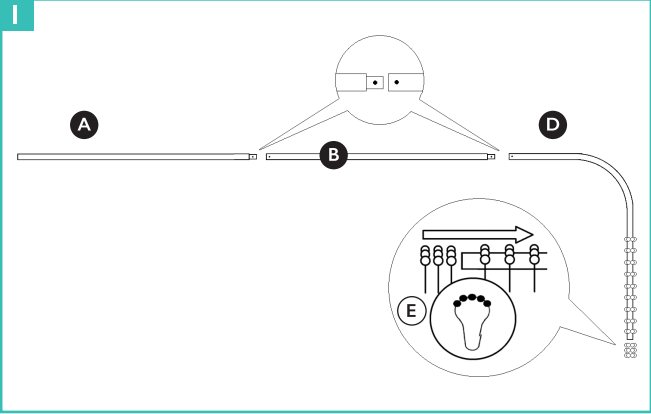

Problem solutions and
FAQs on Page 8
contact: kontakt@laakfeld.de

Problem solutions

PROBLEM 1: THE WALL MOUNT WILL NOT HOLD IN THE WALL

→ **SOLUTION 1:** The expansion anchors included in the delivery can be used without problems for most walls and provide a secure hold. For special wall conditions (e.g. gib board) we recommend the use of special dowels. You can find these at your local hardware store.

PROBLEM 2: THE SHOWER CURTAIN ROD IS SAGGING IN THE MIDDLE

→ **SOLUTION 2:** Please check if the wall brackets are firmly connected to the wall and tighten the screws if necessary.

Disassembly

To dismantle the shower curtain rod, first remove the screws from the wall bracket using a screwdriver or cordless drill. Now the shower curtain rod can be removed from the wall. The connection between the rods can be loosened with a Phillips screwdriver, and the connection between the rods and the wall bracket can be loosened with the enclosed Allen key. The resulting holes in the wall can be filled in most cases with ready-made filler from the hardware store.

CAUTION! We recommend that the disassembly be carried out by another person.

Care instructions

To remove light dirt, we recommend hot water and a sponge. If necessary, you can resort to a little dishwashing liquid.

NOTE! Please do not use aggressive cleaners. In particular, cleaners with hydrofluoric acid and chlorine damage the materials and lead to corrosion damage. You should also refrain from using steel wool, scratching sponge surfaces and scouring agents, as these attack the coating and the aluminum.

FAQs

WHAT IS THE LOAD CAPACITY OF THE SHOWER CURTAIN ROD?

→ The shower curtain rod is designed for high stability. Nevertheless, the shower curtain rod should be loaded only with shower curtains usual for a bathroom.

WHERE CAN I REORDER INDIVIDUAL SPARE PARTS?

→ Since the demand for individual parts is very low, we do not offer them for sale on a regular basis. However, if you have a need, please contact us at any time at **kontakt@laakfeld.de**. We will find an individual solution for you.

THE DELIVERY WAS INCOMPLETE - WHAT SHOULD I DO?

→ Contact us at **kontakt@laakfeld**. We will find an individual solution for you.

WHERE CAN I GET FURTHER SUPPORT?

→ If you have any questions and/or problems, please feel free to contact us anytime via mail at **kontakt@laakfeld**.



DURABLE. RELIABLE. RESPONSIBLE.



Distribution: Laakfeld GmbH | Pfingstbrunnenstr. 28 | 60486 Frankfurt

**Klimaneutrales
Unternehmen**
2021 / 2022

LAAKFELD
Laakfeld GmbH
Pfingstbrunnenstr. 28
60486 Frankfurt

CO₂ KOMPENSATION NACH DREP STANDARD
SEHR GUT
★★★★★

DIOP
Deutsches Institut
für Qualitätsstandards und -prüfung e.V.

Alle Kriterien unserer Produktlinien finden Sie unter: www.dio.de